

ITEM NO.	PART NUMBER	DESCRIPTION	Explode/QTY.
1	C100107		1
2	B120044	EQ/AQ/IQ Shaft - 2 x Mech	1
3	B120003	Cam	2
4	B120004	Standard Spline	2
5	B120006	Roll Pin	2
6	407001	Housing O-Ring	1
7	407003	Shaft O-Ring	2
8	B130015	V3 Plate	1
9	A140002	V3 Mechanical - Gold Plated	2
10	413001	Switch Insulator	5
11	A100019	M3 Lockwasher SS	2
12	A100015	M3 x 30 Pan Hd	2
13	A110008	MK3-8 Terminal Block	1
14	411004	Switch Top Plate	1
15	A100098	M4 x 5 Pan Hd SS	2
16	A100164	M3 x 12 Pan Hd Screw	2
17	402039	Outer Indicator	1
18	403045	Drive Piece	1
19	404003	Inner Indicator Drum	1
20	416039	Inner Indicator Label	1
21	416142	Outer Indicator Label	2
22	407004	Indicator O-Ring	1
23	A100096	M4 x 8 Set Screw	1
24	C110102		1
25	A160103	IQ Generic Plate	1
26	9101702	External Earth Clamp	1
27	9101703	M4 x 8 Pan Head SS Screw	1
28	9101704	M4 Lockwasher SS	2
29	408002	Set Screw	1

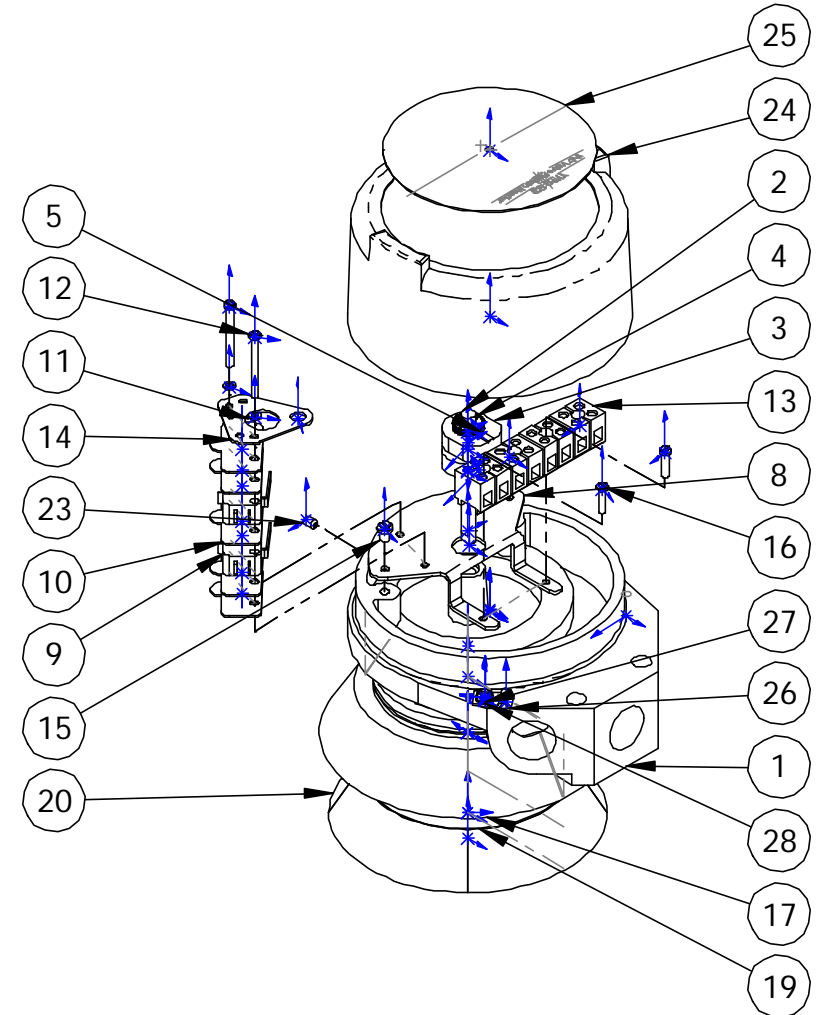

<p>This private &amp; confidential drawing is the property of Imtex Controls Limited, Tonbridge, UK and cannot be copied or reproduced without the express written permission of the Company.</p>	<table border="1"> <tr> <th>REV</th> <th>DRAWN</th> <th>DATE</th> <th>CHK'D</th> <th>ECO</th> </tr> <tr> <td>-</td> <td>PT</td> <td>28.7.04</td> <td></td> <td></td> </tr> </table>	REV	DRAWN	DATE	CHK'D	ECO	-	PT	28.7.04			<p>UNLESS OTHERWISE SPECIFIED: DIMENSIONS ARE IN MILLIMETERS SURFACE FINISH: TOLERANCES: LINEAR: ANGULAR:</p>	<p>TITLE:</p>	
	REV	DRAWN	DATE	CHK'D	ECO									
-	PT	28.7.04												
<p>Imtex Controls Limited Unit 5A, Valley Industries, Hadlow Road Tonbridge, Kent, TN11 0AH, United Kingdom Tel: +44(0)1732-850360 Fax: +44(0)1732-852133 Website: <a href="http://www.imtex-controls.com">www.imtex-controls.com</a></p>	<p>DEBUR AND BREAK SHARP EDGES</p> <p>MATERIAL:</p> <p>WEIGHT(g): 2560.58</p>	<p>DWG NO.</p> <p><b>IQ17S5SR-000</b></p> <p>SCALE: 1:5</p>	<p>A4</p>	<p>SHEET 1 OF 1</p>										